



LOGISTICS



Origi Logistics is a high quality professional luminaire for logistics buildings, taking the life cycle of logistics lighting to a new era. The design and philosophy of the luminaire makes it completely exceptional compared to any other luminaire on the market. With its long warranty, unlimited serviceability and stunning light output, Origi is the last luminaire you'll ever need to buy.

For the lighting designer and user, Origi provides high quality lighting with low glare, supporting visual efficiency, work safety and flawlessness. The luminaire meets the highest requirements of the EN-12464-1 indoor lighting standard. The Origi body is designed to be eternal and reusable and is made of recycled aluminium, minimising the impact on nature.

---

**Area of use:** logistics and warehouses

**Installation:** ceiling surface, suspension and hanging rail

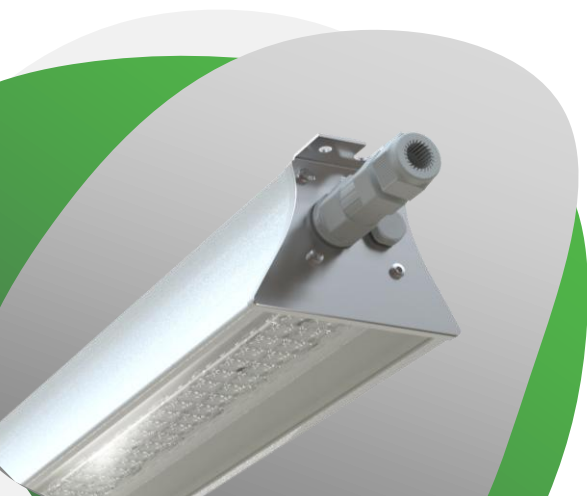

## BENEFITS

**Life cycle:** Origi is the first professional luminaire designed to last forever without compromising on components. Energy efficiency (154-**204lm/W**), intelligence and optics, guaranteeing low kWh/m<sup>2</sup> results. L90/100 000 h and CLO allow the use of a low maintenance factor in lighting design, supporting EPBD efficient w/m<sup>2</sup> calculation.

### Design.

**Luminaire-specific sensor:** Versions equipped with a motion and presence sensor, has an NLC Bluetooth or Casambi sensor embedded in the end cap for improved wireless network coverage.

**Maintainability:** the luminaire is maintainable with Zhaga standard components by Greenled and other lighting professionals. It is compatible with Zhaga Book 7 standard linear LED cards and optics and all Zhaga Book 15 standard LED cards and optics. In addition, the luminaire can be used with Zhaga Book 13 linear LED drivers. The Zhaga Book 20 and Zhaga Book 25 standards ensure serviceability and availability of spare parts.

**DALI2 data** support for smart homes (EPBD-SRI), and DiiA certified features (251, 252, 253) allow data storage, energy reporting, diagnostics (overvoltage and thermal) and proactive failure information 1000-5000 h before end of life (control management system support required).

**Price and warranty:** despite its superior life cycle, Origi is very price competitive compared to any similar product.

## SUITABILITY

**Logistics sites of all sizes** where quality and ease of maintenance are important. Origin's serviceability allows for a radical reduction in property maintenance costs, as well as comfort. The luminaire is available in 3 different lengths.

**Installation.** Connection of the luminaire from the end with a quick coupling.

Origi is suitable for **both wireless and wired** control



VARIANTS

Model	Type code	Power	Luminous flux	Luminaire efficacy	Lifetime	Operating temperature
Origi Logistics 1200	GLORLO12024	24 W	4726 lm	194 lm/W	L90B50 >100 000h, C10 100 000h	-25 - +50°C
Origi Logistics 1200	GLORLO12032	32 W	6082 lm	187 lm/W	L90B50 >100 000h, C10 100 000h	-25 - +50°C
Origi Logistics 1200	GLORLO12049	49 W	8664 lm	175 lm/W	L90B50 >100 000h, C10 100 000h	-25 - +50°C
Origi Logistics 1200	GLORLO12070	70 W	11371 lm	163 lm/W	L90B50 >100 000h, C10 100 000h	-25 - +45°C
Origi Logistics 1200	GLORLO12084	84 W	13066 lm	156 lm/W	L90B50 >100 000h, C10 100 000h	-25 - +40°C
Origi Logistics 1800	GLORLO18051	51 W	9621 lm	188 lm/W	L90B50 >100 000h, C10 100 000h	-25 - +50°C
Origi Logistics 1800	GLORLO18066	66 W	11861 lm	181 lm/W	L90B50 >100 000h, C10 100 000h	-25 - +50°C
Origi Logistics 1800	GLORLO18093	93 W	15737 lm	169 lm/W	L90B50 >100 000h, C10 100 000h	-25 - +50°C
Origi Logistics 1800	GLORLO18125	125 W	19599 lm	157 lm/W	L90B50 >100 000h, C10 100 000h	-25 - +40°C
Origi Logistics 2400	GLORLO24064	64 W	12164 lm	191 lm/W	L90B50 >100 000h, C10 100 000h	-25 - +50°C
Origi Logistics 2400	GLORLO24093	93 W	16701 lm	180 lm/W	L90B50 >100 000h, C10 100 000h	-25 - +50°C
Origi Logistics 2400	GLORLO24132	132 W	22161 lm	168 lm/W	L90B50 >100 000h, C10 100 000h	-25 - +50°C
Origi Logistics 2400	GLORLO24184	184 W	28297 lm	154 lm/W	L90B50 >100 000h, C10 100 000h	-25 - +40°C
Origi Logistics 2400R2	GLORLO24095	95 W	19326 lm	204 lm/W	L90B50 >100 000h, C10 100 000h	-25 - +50°C
Origi Logistics 2400R2	GLORLO24167	167 W	30863 lm	185 lm/W	L90B50 >100 000h, C10 100 000h	-25 - +50°C
Origi Logistics 2400R2	GLORLO24179	179 W	32920 lm	184 lm/W	L90B50 >100 000h, C10 100 000h	-25 - +50°C
Origi Logistics 2400R2	GLORLO24270	270 W	45485 lm	169 lm/W	L90B50 >100 000h, C10 100 000h	-25 - +45°C

**Notes**  
All values at +25°C ambient temperature, CCT 4000K, CRI 80, luminous flux +-10% tolerance, power +-10% tolerance. The luminaire is 10% CLO compensated. Please note LMS (lumen maintenance factor).



DIMENSIONS

Model	Type code	Length (L)	Height (H)	Width (W)
Origi Logistics 1200	GLORLO12024	1161mm	78mm	108mm
Origi Logistics 1200	GLORLO12032	1161mm	78mm	108mm
Origi Logistics 1200	GLORLO12049	1161mm	78mm	108mm
Origi Logistics 1200	GLORLO12070	1161mm	78mm	108mm
Origi Logistics 1200	GLORLO12084	1161mm	78mm	108mm
Origi Logistics 1800	GLORLO18051	1738mm	78mm	108mm
Origi Logistics 1800	GLORLO18066	1738mm	78mm	108mm
Origi Logistics 1800	GLORLO18093	1738mm	78mm	108mm
Origi Logistics 1800	GLORLO18125	1738mm	78mm	108mm
Origi Logistics 2400	GLORLO24064	2315mm	78mm	108mm
Origi Logistics 2400	GLORLO24093	2315mm	78mm	108mm
Origi Logistics 2400	GLORLO24132	2315mm	78mm	108mm
Origi Logistics 2400	GLORLO24184	2315mm	78mm	108mm
Origi Logistics 2400R2	GLORLO24095	2315mm	78mm	108mm
Origi Logistics 2400R2	GLORLO24167	2315mm	78mm	108mm
Origi Logistics 2400R2	GLORLO24179	2315mm	78mm	108mm
Origi Logistics 2400R2	GLORLO24270	2315mm	78mm	108mm



## GENERAL DESCRIPTION

**Colour temperature**  
3000, 4000, 5000, K (1)

**Colour rendering index**  
RA ≥ 80

**Light source shield**  
PMMA

**Enclosure class**  
IP23

**Supply voltage:**  
220-240 Vac

**Frequency:**  
50-60 Hz

**PF:**  
> 0.90

**THD:**  
< 20%

**Connection:**  
1pc quick connector, 2pc quick connector chainable  
max 5\*2,5mm<sup>2</sup> OR max 3\*2,5mm<sup>2</sup> and DALI +/-.

**Controllability:**  
DALI2 data, On/Off(CLO), NLC node, NLC + PIR  
sensor, Casambi+ PIR sensor

**Colour:**  
Aluminium

**Material of the luminaire body:**  
Recycled aluminium

**Guarantee:**  
5 years or 8 years. Luminaire-specific sensors 2 years  
or 5 years

**CLO (Constant Light Output).**  
CLO: the luminaire maintains the same light output  
throughout its 100 000h life. CLO programming 10%.  
All ON/OFF, DALI and wireless LED drivers

**Accessories (installation):**  
E1500191 Origi adjustable roof bracket, E1500187 Origi  
MEK bracket 50-80mm RST, E1500198 Origi MEK  
bracket 80-120mm RST, E1500200 Origi adjustable  
mek 70mm bracket, E1500199 Origi adjustable mek  
110-120mm bracket, E1500196 Origi Origi Suspension  
wire bracket 3m, E1500195 Origi Origi Suspension  
wire bracket 5m, E1500201 Origi Horizontal wire  
bracket

**Notes:**  
1) SDCM ≤ 3

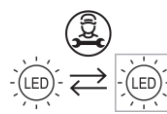

LIGHT DISTRIBUTION

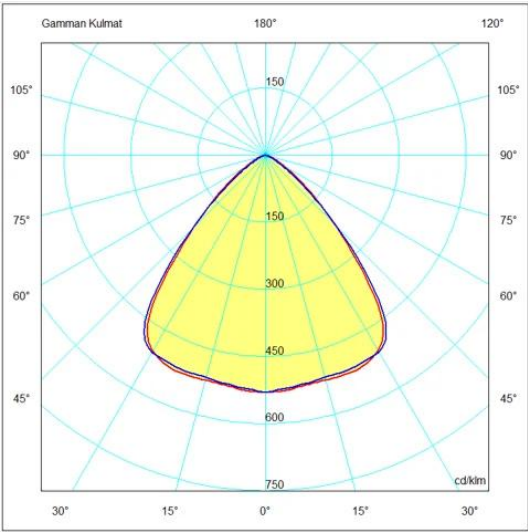

Origi Logistics wide

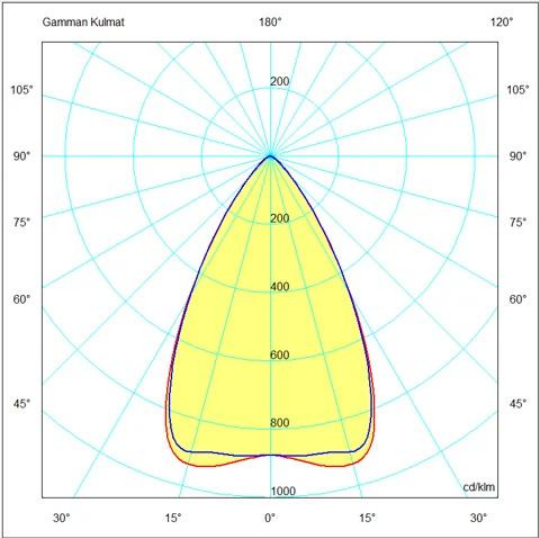

Origi Logistics medium

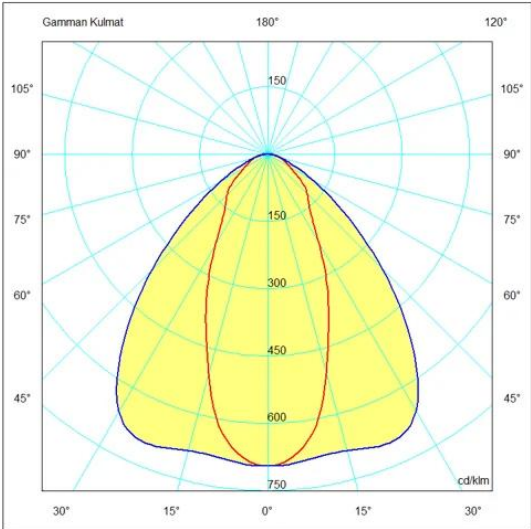

Origi Logistics high rack

DIMENSIONS

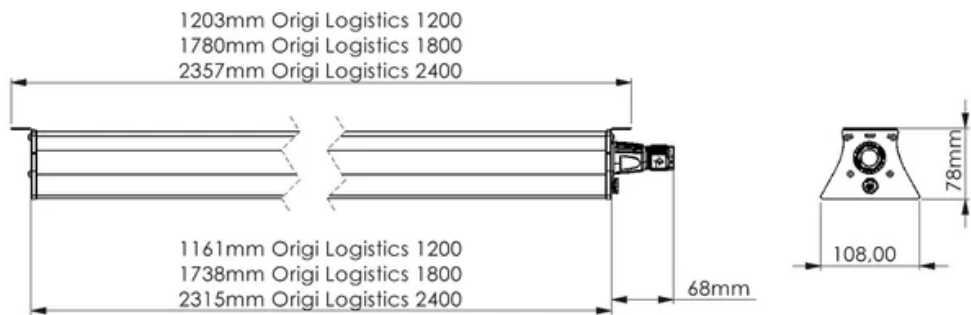

BRACKETS

E1500191 Origi adjustable roof bracket

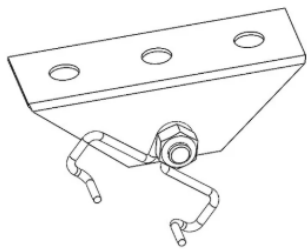

E1500187 Origi MEK bracket 50-80mm RST

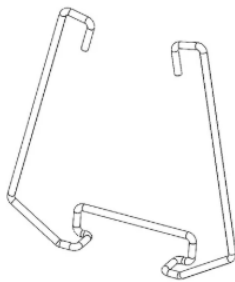

E1500198 Origi MEK bracket 80-120mm RST

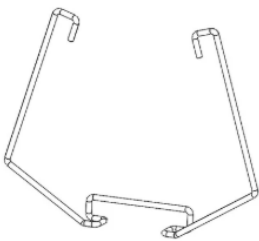

E1500200 Origi adjustable mek 70mm bracket

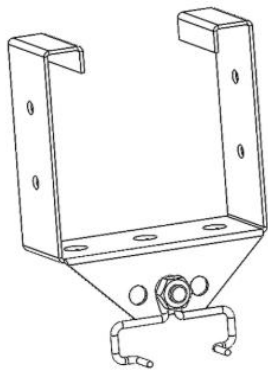

E1500199 Origi adjustable mek 110-120mm bracket

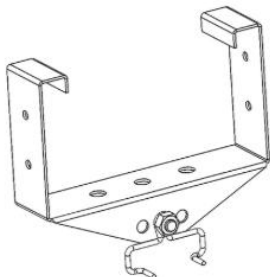

E1500196 Origi Suspension wire bracket 3m



E1500195 Origi Suspension wire bracket 5m



E1500201 Origi Horizontal wire bracket

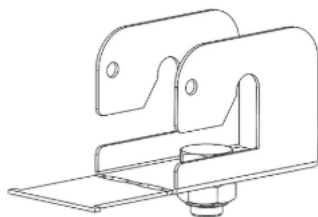





CIRCUIT BREAKERS

	B10	B16	B20	C10	C16	C20
14-35W	17	28	31	26	42	52
36-75 W	14	23	25	21	34	43
76-151W	8	13	16	12	20	24
152-300W	7	11	13	11	17	20

GREENLED OY

Oritkarintie 4  
90400 Oulu  
p. +358 20 125 5800

